

PHILIPPINE BIDDING DOCUMENTS

(As Harmonized with Development Partners)



Procurement of INFRASTRUCTURE PROJECTS Construction of Farm to Market Road at Sitio Papatahan

Government of the Republic of the Philippines

**Sixth Edition
July 2020**

Preface

These Philippine Bidding Documents (PBDs) for the procurement of Infrastructure Projects (hereinafter referred to also as the “Works”) through Competitive Bidding have been prepared by the Government of the Philippines for use by all branches, agencies, departments, bureaus, offices, or instrumentalities of the government, including government-owned and/or -controlled corporations, government financial institutions, state universities and colleges, local government units, and autonomous regional government. The procedures and practices presented in this document have been developed through broad experience, and are for mandatory use in projects that are financed in whole or in part by the Government of the Philippines or any foreign government/foreign or international financing institution in accordance with the provisions of the 2016 revised Implementing Rules and Regulations (IRR) of Republic Act (RA) No. 9184.

The PBDs are intended as a model for admeasurements (unit prices or unit rates in a bill of quantities) types of contract, which are the most common in Works contracting.

The Bidding Documents shall clearly and adequately define, among others: (i) the objectives, scope, and expected outputs and/or results of the proposed contract; (ii) the eligibility requirements of Bidders; (iii) the expected contract duration; and (iv) the obligations, duties, and/or functions of the winning Bidder.

Care should be taken to check the relevance of the provisions of the PBDs against the requirements of the specific Works to be procured. If duplication of a subject is inevitable in other sections of the document prepared by the Procuring Entity, care must be exercised to avoid contradictions between clauses dealing with the same matter.

Moreover, each section is prepared with notes intended only as information for the Procuring Entity or the person drafting the Bidding Documents. They shall not be included in the final documents. The following general directions should be observed when using the documents:

- a. All the documents listed in the Table of Contents are normally required for the procurement of Infrastructure Projects. However, they should be adapted as necessary to the circumstances of the particular Project.
- b. Specific details, such as the “*name of the Procuring Entity*” and “*address for bid submission*,” should be furnished in the Instructions to Bidders, Bid Data Sheet, and Special Conditions of Contract. The final documents should contain neither blank spaces nor options.
- c. This Preface and the footnotes or notes in italics included in the Invitation to Bid, BDS, General Conditions of Contract, Special Conditions of Contract, Specifications, Drawings, and Bill of Quantities are not part of the text of the final document, although they contain instructions that the Procuring Entity should strictly follow.
- d. The cover should be modified as required to identify the Bidding Documents as to the names of the Project, Contract, and Procuring Entity, in addition to date of issue.

- e. Modifications for specific Procurement Project details should be provided in the Special Conditions of Contract as amendments to the Conditions of Contract. For easy completion, whenever reference has to be made to specific clauses in the Bid Data Sheet or Special Conditions of Contract, these terms shall be printed in bold typeface on Sections I (Instructions to Bidders) and III (General Conditions of Contract), respectively.

- f. For guidelines on the use of Bidding Forms and the procurement of Foreign-Assisted Projects, these will be covered by a separate issuance of the Government Procurement Policy Board.

TABLE OF CONTENTS

Glossary of Terms, Abbreviations, and Acronyms	5
Section I. Invitation to Bid.....	8
Section II. Instructions to Bidders	12
1. Scope of Bid.....	14
2. Funding Information	14
3. Bidding Requirements.....	14
4. Corrupt, Fraudulent, Collusive, Coercive, and Obstructive Practices	14
5. Eligible Bidders.....	15
6. Origin of Associated Goods	15
7. Subcontracts	15
8. Pre-Bid Conference.....	16
9. Clarification and Amendment of Bidding Documents.....	16
10. Documents Comprising the Bid: Eligibility and Technical Components	16
11. Documents Comprising the Bid: Financial Component	17
12. Alternative Bids	17
13. Bid Prices	17
14. Bid and Payment Currencies.....	17
15. Bid Security.....	18
16. Sealing and Marking of Bids.....	18
17. Deadline for Submission of Bids	18
18. Opening and Preliminary Examination of Bids	18
19. Detailed Evaluation and Comparison of Bids	18
20. Post Qualification.....	19
21. Signing of the Contract	19
Section III. Bid Data Sheet	20
Section IV. General Conditions of Contract.....	23
1. Scope of Contract.....	24
2. Sectional Completion of Works	24
3. Possession of Site	24
4. The Contractor's Obligations.....	24
5. Performance Security	25
6. Site Investigation Reports	25

7.	Warranty.....	25
8.	Liability of the Contractor.....	25
9.	Termination for Other Causes.....	25
10.	Dayworks	26
11.	Program of Work.....	26
12.	Instructions, Inspections and Audits	26
13.	Advance Payment.....	26
14.	Progress Payments	26
15.	Operating and Maintenance Manuals.....	26
Section V. Special Conditions of Contract.....		28
Section VI. Specifications		30
Section VII. Drawings.....		31
Section VIII. Bill of Quantities.....		35
Section IX. Checklist of Technical and Financial Documents		52

Glossary of Terms, Abbreviations, and Acronyms

ABC – Approved Budget for the Contract.

ARCC – Allowable Range of Contract Cost.

BAC – Bids and Awards Committee.

Bid – A signed offer or proposal to undertake a contract submitted by a bidder in response to and in consonance with the requirements of the bidding documents. Also referred to as *Proposal* and *Tender*. (2016 revised IRR, Section 5[c])

Bidder – Refers to a contractor, manufacturer, supplier, distributor and/or consultant who submits a bid in response to the requirements of the Bidding Documents. (2016 revised IRR, Section 5[d])

Bidding Documents – The documents issued by the Procuring Entity as the bases for bids, furnishing all information necessary for a prospective bidder to prepare a bid for the Goods, Infrastructure Projects, and/or Consulting Services required by the Procuring Entity. (2016 revised IRR, Section 5[e])

BIR – Bureau of Internal Revenue.

BSP – Bangko Sentral ng Pilipinas.

CDA – Cooperative Development Authority.

Consulting Services – Refer to services for Infrastructure Projects and other types of projects or activities of the GOP requiring adequate external technical and professional expertise that are beyond the capability and/or capacity of the GOP to undertake such as, but not limited to: (i) advisory and review services; (ii) pre-investment or feasibility studies; (iii) design; (iv) construction supervision; (v) management and related services; and (vi) other technical services or special studies. (2016 revised IRR, Section 5[i])

Contract – Refers to the agreement entered into between the Procuring Entity and the Supplier or Manufacturer or Distributor or Service Provider for procurement of Goods and Services; Contractor for Procurement of Infrastructure Projects; or Consultant or Consulting Firm for Procurement of Consulting Services; as the case may be, as recorded in the Contract Form signed by the parties, including all attachments and appendices thereto and all documents incorporated by reference therein.

Contractor – is a natural or juridical entity whose proposal was accepted by the Procuring Entity and to whom the Contract to execute the Work was awarded. Contractor as used in these Bidding Documents may likewise refer to a supplier, distributor, manufacturer, or consultant.

CPI – Consumer Price Index.

DOLE – Department of Labor and Employment.

DTI – Department of Trade and Industry.

Foreign-funded Procurement or Foreign-Assisted Project – Refers to procurement whose funding source is from a foreign government, foreign or international financing institution as specified in the Treaty or International or Executive Agreement. (2016 revised IRR, Section 5[b]).

GFI – Government Financial Institution.

GOCC – Government-owned and/or –controlled corporation.

Goods – Refer to all items, supplies, materials and general support services, except Consulting Services and Infrastructure Projects, which may be needed in the transaction of public businesses or in the pursuit of any government undertaking, project or activity, whether in the nature of equipment, furniture, stationery, materials for construction, or personal property of any kind, including non-personal or contractual services such as the repair and maintenance of equipment and furniture, as well as trucking, hauling, janitorial, security, and related or analogous services, as well as procurement of materials and supplies provided by the Procuring Entity for such services. The term “related” or “analogous services” shall include, but is not limited to, lease or purchase of office space, media advertisements, health maintenance services, and other services essential to the operation of the Procuring Entity. (2016 revised IRR, Section 5[r])

GOP – Government of the Philippines.

Infrastructure Projects – Include the construction, improvement, rehabilitation, demolition, repair, restoration or maintenance of roads and bridges, railways, airports, seaports, communication facilities, civil works components of information technology projects, irrigation, flood control and drainage, water supply, sanitation, sewerage and solid waste management systems, shore protection, energy/power and electrification facilities, national buildings, school buildings, hospital buildings, and other related construction projects of the government. Also referred to as *civil works or works*. (2016 revised IRR, Section 5[u])

LGUs – Local Government Units.

NFCC – Net Financial Contracting Capacity.

NGA – National Government Agency.

PCAB – Philippine Contractors Accreditation Board.

PhilGEPS - Philippine Government Electronic Procurement System.

Procurement Project – refers to a specific or identified procurement covering goods, infrastructure project or consulting services. A Procurement Project shall be described, detailed, and scheduled in the Project Procurement Management Plan prepared by the agency which shall be consolidated in the procuring entity's Annual Procurement Plan. (GPPB Circular No. 06-2019 dated 17 July 2019)

PSA – Philippine Statistics Authority.

SEC – Securities and Exchange Commission.

SLCC – Single Largest Completed Contract.

UN – United Nations.

Section I. Invitation to Bid

Notes on the Invitation to Bid

The Invitation to Bid (IB) provides information that enables potential Bidders to decide whether to participate in the procurement at hand. The IB shall be posted in accordance with Section 21.2 of the 2016 revised IRR of RA No. 9184.

Apart from the essential items listed in the Bidding Documents, the IB should also indicate the following:

- a. The date of availability of the Bidding Documents, which shall be from the time the IB is first advertised/posted until the deadline for the submission and receipt of bids;
- b. The place where the Bidding Documents may be acquired or the website where it may be downloaded;
- c. The deadline for the submission and receipt of bids; and
- d. Any important bid evaluation criteria.

The IB should be incorporated into the Bidding Documents. The information contained in the IB must conform to the Bidding Documents and in particular to the relevant information in the Bid Data Sheet.



Republic of the Philippines
Province of Laguna
Municipality of Paete

Tel. Nos. (049) 501-6490-101, (049) 557-0001

**Invitation to Bid for Construction of Farm to Market Road
at Sitio Papatahan**

- The *Municipality of Paete, Laguna*, through the *LGSF-FALGU Year 2021* intends to apply the sum of *fifteen million pesos only (Php 15,000,000.00)* being the Approved Budget for the Contract (ABC) to payments under the contract for the *Construction of Farm to market Road at Sitio Papapathan Barangay 9 Ibaba del Norte, Paete, Laguna*. Bids received in excess of the ABC shall be automatically rejected at bid opening.

Description of Work

Project	: CONSTRUCTION OF FARM TO MARKET ROAD			Net Length	: 840 meters			
Location	: Sitio Papatahan, Brgy. 9 Ibaba del Norte, Paete, Laguna			Target Start Date	:			
Station Limits	:			Total Project Duration	: 150 C.D.			
Appropriation	: Php15,000,000.00			No. of Pre-determined	:			
ITEM	DESCRIPTION OF WORKS TO BE DONE	Quantity	Unit	%TOTAL	AS SUBMITTED	AS EVALUATED		TOTAL COST
					TOTAL DIRECT COST	TOTAL DIRECT COST	TOTAL INDIRECT COST	
PART A	FACILITIES FOR THE ENGINEER	1	Lump-Sum					
PART B	OTHER GENERAL REQUIREMENTS	1	Lump-Sum					
PART C	EARTHWORKS	1	Lump-Sum					
PART D	SUBBASE AND BASE COURSE	1	Lump-Sum					
PART E	SURFACE COURSES (GAD RELATED ACTIVITIES)	1	Lump-Sum					
PART F	DRAINAGE AND SLOPE PROTECTION STRUCTURES	1	Lump-Sum					
Total Cost								

- The *Municipality of Paete, Laguna* now invites bids for the above Procurement Project. Completion of the Works is required *150 calendar days*. Bidders should have completed a contract similar to the Project. The description of an eligible bidder is contained in the Bidding Documents, particularly, in Section II (Instructions to Bidders).
- Bidding will be conducted through open competitive bidding procedures using non-discretionary “*pass/fail*” criterion as specified in the 2016 revised Implementing Rules and Regulations (IRR) of Republic Act (RA) No. 9184.
- Interested bidders may obtain further information from *Municipality of Paete, Laguna* and inspect the Bidding Documents at the address given below from **8:00 am to 5:00 pm Monday to Friday**.
- A complete set of Bidding Documents may be acquired by interested bidders on **September 1-23, 2021@9:00 am** from given address and website/s upon payment of a nonrefundable fee for the Bidding Documents in the amount of **twenty-five thousand pesos only (Php 25,000.00)**. It may also be downloaded free of charge from the website of the Philippine Government Electronic Procurement System (PhilGEPS) and the

website of the Procuring Entity, provided that bidders shall pay the applicable fee for the Bidding Documents not later than the submission of their bids. The Procuring Entity shall allow the bidder to present its proof of payment for the fees ***presented in person through BAC Secretariat.***

6. The *Municipality of Paete, Laguna* will hold a Pre-Bid Conference¹ on ***September 8, 2021@ 10:00 pm*** at ***Municipal Building, Municipal Hall J.V. Quesada St. Barangay 1, Paete, Laguna*** which shall be open to prospective bidders.
7. Bids must be duly received by the BAC Secretariat through manual submission at the office address as indicated below on or before ***September 23, 2021@ 9:00 am.*** Late bids shall not be accepted.
8. All bids must be accompanied by a bid security in any of the acceptable forms and in the amount stated in **ITB** Clause 16.
9. Bid opening shall be on ***September 23, 2021@10:00 am*** at the given address below ***Municipal Building, Municipal Hall, J.V. Quesada St. Brgy 1, Paete, Laguna*** Bids will be opened in the presence of the bidders' representatives who choose to attend the activity.

The schedule of BAC activities is as follows:

BAC Activities	Schedule
1.Pre-Procurement Conference	August 19, 2021
2. Advertisement/Issuance of Bidding Documents	September 1-23, 2021
3. Pre-bid Conference	Sep. 8, 2021 @10:00 am
4.Deadline of Submission of Bids	September 23, 2021 @9:00 am
5. Opening of Bids	September 23, 2021 @10:00 am
6. Bid Evaluation	September 24, 2021
7. Post-qualification	September 27-28, 2021
8. Notice of Award	September 30, 2021
9. Contract Agreement	October 11, 2021

¹ May be deleted in case the ABC is less than One Million Pesos (PhP1,000,000) where the Procuring Entity may not hold a pre-bid conference.

10. Notice to Proceed	October 12, 2021
-----------------------	------------------

10. The *Municipality Of Paete, Laguna* reserves the right to reject any and all bids, declare a failure of bidding, or not award the contract at any time prior to contract award in accordance with Sections 35.6 and 41 of the 2016 revised Implementing Rules and Regulations (IRR) of RA No. 9184, without thereby incurring any liability to the affected bidder or bidders.

11. For further information, please refer to:

Christine M. Cainto
Bac Secretariat
J.V. Quesada St. B-1 Paete, Laguna
odacrem_12@yahoo.com
049-501-6490-101
Paete.gov.ph

12. You may visit the following websites:

For downloading of Bidding Documents: www.philgeps.gov.ph and www.Paete.gov.ph

ANTONIO C. DELA ROSA
BAC CHAIRMAN

Section II. Instructions to Bidders

Notes on the Instructions to Bidders

This Section on the Instruction to Bidders (ITB) provides the information necessary for bidders to prepare responsive bids, in accordance with the requirements of the Procuring Entity. It also provides information on bid submission, eligibility check, opening and evaluation of bids, post-qualification, and on the award of contract.

INSTRUCTIONS TO BIDDERS

1. Introduction

The Municipality of Paete, Laguna, through the LSGF-FALGU Year 2021. intends to apply the sum of fifteen million pesos only (Php 15,000,000.00) being the Approved Budget for the Contract (ABC) to payments under the contract for the Construction of Farm to market Road at Sitio Papaptahan Barangay 9 Ibaba del Norte, Paete, Laguna The bidding process assumes the following timetable:

BAC Activities	Schedule
1.Pre-Procurement Conference	August 19, 2021
2. Advertisement/Issuance of Bidding Documents	September 1-23, 2021
3. Pre-bid Conference	Sep. 8, 2021 @10:00 am
4.Deadline of Submission of Bids	September 23, 2021 @9:00 am
5. Opening of Bids	September 23, 2021 @10:00 am
6. Bid Evaluation	September 24, 2021
7. Post-qualification	September 27-28, 2021
8. Notice of Award	September 30, 2021

The eligibility and technical documents of the Bid as specified in Section IX. Checklist of Technical and Financial Documents.

1.Affidavit of site Inspection.

2. Please read Bid Data Sheet for additional requirements.

Note: deadline of Submission is on September 23, 2021 @9:00 am based on the Municipal Bundy clock, Late bids will not be accepted.

ANTONIO C. DELA ROSA

BAC Chairman

1. Scope of Bid

The Procuring Entity, *Municipality of Paete, Laguna* invites Bids for the Construction of Farm to market Road at Sitio Papaptahan Barangay 9 Ibaba del Norte, Paete, Laguna, with Project Identification Number *IP-012-21ROAD*.

[Note: The Project Identification Number is assigned by the Procuring Entity based on its own coding scheme and is not the same as the PhilGEPS reference number, which is generated after the posting of the bid opportunity on the PhilGEPS website.]

The Procurement Project (referred to herein as “Project”) is for the construction of Works, as described in Section VI (Specifications).

2. Funding Information

2.1. The GOP through the source of funding as indicated below for **year 2021** in the amount of ***Fifteen million pesos only (Php 15,000,000.00)***.

2.2. The source of funding is:

a. NGA, the General Appropriations Act or Special Appropriations.

3. Bidding Requirements

The Bidding for the Project shall be governed by all the provisions of RA No. 9184 and its 2016 revised IRR, including its Generic Procurement Manual and associated policies, rules and regulations as the primary source thereof, while the herein clauses shall serve as the secondary source thereof.

Any amendments made to the IRR and other GPPB issuances shall be applicable only to the ongoing posting, advertisement, or invitation to bid by the BAC through the issuance of a supplemental or bid bulletin.

The Bidder, by the act of submitting its Bid, shall be deemed to have inspected the site, determined the general characteristics of the contracted Works and the conditions for this Project, such as the location and the nature of the work; (b) climatic conditions; (c) transportation facilities; (c) nature and condition of the terrain, geological conditions at the site communication facilities, requirements, location and availability of construction aggregates and other materials, labor, water, electric power and access roads; and (d) other factors that may affect the cost, duration and execution or implementation of the contract, project, or work and examine all instructions, forms, terms, and project requirements in the Bidding Documents.

4. Corrupt, Fraudulent, Collusive, Coercive, and Obstructive Practices

The Procuring Entity, as well as the Bidders and Contractors, shall observe the highest standard of ethics during the procurement and execution of the contract. They or through an agent shall not engage in corrupt, fraudulent, collusive, coercive, and

obstructive practices defined under Annex “I” of the 2016 revised IRR of RA No. 9184 or other integrity violations in competing for the Project.

5. Eligible Bidders

- 5.1. Only Bids of Bidders found to be legally, technically, and financially capable will be evaluated.
- 5.2. The Bidder must have an experience of having completed a Single Largest Completed Contract (SLCC) that is similar to this Project, equivalent to at least fifty percent (50%) of the ABC adjusted, if necessary, by the Bidder to current prices using the PSA’s CPI, except under conditions provided for in Section 23.4.2.4 of the 2016 revised IRR of RA No. 9184.

A contract is considered to be “similar” to the contract to be bid if it has the major categories of work stated in the **BDS**.

- 5.3. For Foreign-funded Procurement, the Procuring Entity and the foreign government/foreign or international financing institution may agree on another track record requirement, as specified in the Bidding Document prepared for this purpose.
- 5.4. The Bidders shall comply with the eligibility criteria under Section 23.4.2 of the 2016 IRR of RA No. 9184.

6. Origin of Associated Goods

There is no restriction on the origin of Goods other than those prohibited by a decision of the UN Security Council taken under Chapter VII of the Charter of the UN.

7. Subcontracts

- 7.1. The Bidder may subcontract portions of the Project to the extent allowed by the Procuring Entity as stated herein, but in no case more than fifty percent (50%) of the Project.

The Procuring Entity has prescribed that:

- a. Subcontracting is not allowed.

- 7.1. *[If Procuring Entity has determined that subcontracting is allowed during the bidding , state:]* The Bidder must submit together with its Bid the documentary requirements of the subcontractor(s) complying with the eligibility criterial stated in **ITB** Clause 5 in accordance with Section 23.4 of the 2016 revised IRR of RA No. 9184 pursuant to Section 23.1 thereof.

- 7.2. *[If subcontracting is allowed during the contract implementation stage, state:]* The Supplier may identify its subcontractor during the contract implementation stage. Subcontractors identified during the bidding may be

changed during the implementation of this Contract. Subcontractors must submit the documentary requirements under Section 23.1 of the 2016 revised IRR of RA No. 9184 and comply with the eligibility criteria specified in **ITB** Clause 5 to the implementing or end-user unit.

- 7.3. Subcontracting of any portion of the Project does not relieve the Contractor of any liability or obligation under the Contract. The Supplier will be responsible for the acts, defaults, and negligence of any subcontractor, its agents, servants, or workmen as fully as if these were the Contractor's own acts, defaults, or negligence, or those of its agents, servants, or workmen.

8. Pre-Bid Conference

The Procuring Entity will hold a pre-bid conference for this Project on the specified date and time and either at its physical address Municipal Building, Municipal Hall J.V. Quesada st. Brgy 1 Paete, Laguna and as indicated in paragraph 6 of the **IB**.

9. Clarification and Amendment of Bidding Documents

Prospective bidders may request for clarification on and/or interpretation of any part of the Bidding Documents. Such requests must be in writing and received by the Procuring Entity, either at its given address or through electronic mail indicated in the **IB**, at least ten (10) calendar days before the deadline set for the submission and receipt of Bids.

10. Documents Comprising the Bid: Eligibility and Technical Components

- 10.1. The first envelope shall contain the eligibility and technical documents of the Bid as specified in **Section IX. Checklist of Technical and Financial Documents**.
- 10.2. If the eligibility requirements or statements, the bids, and all other documents for submission to the BAC are in foreign language other than English, it must be accompanied by a translation in English, which shall be authenticated by the appropriate Philippine foreign service establishment, post, or the equivalent office having jurisdiction over the foreign bidder's affairs in the Philippines. For Contracting Parties to the Apostille Convention, only the translated documents shall be authenticated through an apostille pursuant to GPPB Resolution No. 13-2019 dated 23 May 2019. The English translation shall govern, for purposes of interpretation of the bid.
- 10.3. A valid PCAB License is required, and in case of joint ventures, a valid special PCAB License, and registration for the type and cost of the contract for this Project. Any additional type of Contractor license or permit shall be indicated in the **BDS**.
- 10.4. A List of Contractor's key personnel (e.g., Project Manager, Project Engineers, Materials Engineers, and Foremen) assigned to the contract to be bid, with their complete qualification and experience data shall be provided.

These key personnel must meet the required minimum years of experience set in the **BDS**.

- 10.5. A List of Contractor's major equipment units, which are owned, leased, and/or under purchase agreements, supported by proof of ownership, certification of availability of equipment from the equipment lessor/vendor for the duration of the project, as the case may be, must meet the minimum requirements for the contract set in the **BDS**.

11. Documents Comprising the Bid: Financial Component

- 11.1. The second bid envelope shall contain the financial documents for the Bid as specified in **Section IX. Checklist of Technical and Financial Documents**.
- 11.2. Any bid exceeding the ABC indicated in paragraph 1 of the **IB** shall not be accepted.
- 11.3. For Foreign-funded procurement, a ceiling may be applied to bid prices provided the conditions are met under Section 31.2 of the 2016 revised IRR of RA No. 9184.

12. Alternative Bids

Bidders shall submit offers that comply with the requirements of the Bidding Documents, including the basic technical design as indicated in the drawings and specifications. Unless there is a value engineering clause in the **BDS**, alternative Bids shall not be accepted.

13. Bid Prices

All bid prices for the given scope of work in the Project as awarded shall be considered as fixed prices, and therefore not subject to price escalation during contract implementation, except under extraordinary circumstances as determined by the NEDA and approved by the GPPB pursuant to the revised Guidelines for Contract Price Escalation guidelines.

14. Bid and Payment Currencies

- 14.1. Bid prices may be quoted in the local currency or tradeable currency accepted by the BSP at the discretion of the Bidder. However, for purposes of bid evaluation, Bids denominated in foreign currencies shall be converted to Philippine currency based on the exchange rate as published in the BSP reference rate bulletin on the day of the bid opening.
- 14.2. *Payment of the contract price shall be made in:*
 - a. Philippine Pesos.

15. Bid Security

- 15.1. The Bidder shall submit a Bid Securing Declaration or any form of Bid Security in the amount indicated in the **BDS**, which shall be not less than the percentage of the ABC in accordance with the schedule in the **BDS**.
- 15.2. The Bid and bid security shall be valid until *January 21, 2022*. Any bid not accompanied by an acceptable bid security shall be rejected by the Procuring Entity as non-responsive.

16. Sealing and Marking of Bids

Each Bidder shall submit one copy of the first and second components of its Bid.

The Procuring Entity may request additional hard copies and/or electronic copies of the Bid. However, failure of the Bidders to comply with the said request shall not be a ground for disqualification.

If the Procuring Entity allows the submission of bids through online submission to the given website or any other electronic means, the Bidder shall submit an electronic copy of its Bid, which must be digitally signed. An electronic copy that cannot be opened or is corrupted shall be considered non-responsive and, thus, automatically disqualified.

17. Deadline for Submission of Bids

The Bidders shall submit on the specified date and time and either at its physical address or through online submission as indicated in paragraph 7 of the **IB**.

18. Opening and Preliminary Examination of Bids

- 18.1. The BAC shall open the Bids in public at the time, on the date, and at the place specified in paragraph 9 of the **IB**. The Bidders' representatives who are present shall sign a register evidencing their attendance. In case videoconferencing, webcasting or other similar technologies will be used, attendance of participants shall likewise be recorded by the BAC Secretariat.

In case the Bids cannot be opened as scheduled due to justifiable reasons, the rescheduling requirements under Section 29 of the 2016 revised IRR of RA No. 9184 shall prevail.

- 18.2. The preliminary examination of Bids shall be governed by Section 30 of the 2016 revised IRR of RA No. 9184.

19. Detailed Evaluation and Comparison of Bids

- 19.1. The Procuring Entity's BAC shall immediately conduct a detailed evaluation of all Bids rated "*passed*" using non-discretionary pass/fail criteria. The BAC

shall consider the conditions in the evaluation of Bids under Section 32.2 of 2016 revised IRR of RA No. 9184.

- 19.2. If the Project allows partial bids, all Bids and combinations of Bids as indicated in the **BDS** shall be received by the same deadline and opened and evaluated simultaneously so as to determine the Bid or combination of Bids offering the lowest calculated cost to the Procuring Entity. Bid Security as required by **ITB** Clause 16 shall be submitted for each contract (lot) separately.
- 19.3. In all cases, the NFCC computation pursuant to Section 23.4.2.6 of the 2016 revised IRR of RA No. 9184 must be sufficient for the total of the ABCs for all the lots participated in by the prospective Bidder.

20. Post Qualification

Within a non-extendible period of five (5) calendar days from receipt by the Bidder of the notice from the BAC that it submitted the Lowest Calculated Bid, the Bidder shall submit its latest income and business tax returns filed and paid through the BIR Electronic Filing and Payment System (eFPS), and other appropriate licenses and permits required by law and stated in the **BDS**.

21. Signing of the Contract

The documents required in Section 37.2 of the 2016 revised IRR of RA No. 9184 shall form part of the Contract. Additional Contract documents are indicated in the **BDS**.

Section III. Bid Data Sheet

Notes on the Bid Data Sheet (BDS)

The Bid Data Sheet (BDS) consists of provisions that supplement, amend, or specify in detail, information, or requirements included in the ITB found in Section II, which are specific to each procurement.

This Section is intended to assist the Procuring Entity in providing the specific information in relation to corresponding clauses in the ITB and has to be prepared for each specific procurement.

The Procuring Entity should specify in the BDS information and requirements specific to the circumstances of the Procuring Entity, the processing of the procurement, and the bid evaluation criteria that will apply to the Bids. In preparing the BDS, the following aspects should be checked:

- a. Information that specifies and complements provisions of the ITB must be incorporated.
- b. Amendments and/or supplements, if any, to provisions of the ITB as necessitated by the circumstances of the specific procurement, must also be incorporated.

Bid Data Sheet

ITB Clause																																																							
5.2	For this purpose, contracts similar to the Project refer to contracts which have the same major categories of work, which shall be: `road																																																						
7.1	<i>Subcontracting is not allowed.</i>																																																						
10.3	<i>Valid PCAB License</i>																																																						
10.4	The key personnel must meet the required minimum years of experience set below:																																																						
	<table style="width: 100%; border-collapse: collapse;"> <thead> <tr> <th style="text-align: left;"><u>Key Personnel</u></th> <th style="text-align: center;"><u>General Experience</u></th> <th style="text-align: center;"><u>Relevant Experience</u></th> </tr> </thead> <tbody> <tr> <td>Project Manager,</td> <td style="text-align: center;">3 years</td> <td style="text-align: center;">3 years</td> </tr> <tr> <td>Project Engineers</td> <td style="text-align: center;">3 years</td> <td style="text-align: center;">3 years</td> </tr> <tr> <td>Materials Engineers</td> <td style="text-align: center;">3 years</td> <td style="text-align: center;">3 years</td> </tr> <tr> <td>Foremen</td> <td style="text-align: center;">3 years</td> <td style="text-align: center;">3 years</td> </tr> <tr> <td>Leadman</td> <td style="text-align: center;">3 years</td> <td style="text-align: center;">3 years</td> </tr> <tr> <td>Mason</td> <td style="text-align: center;">3 years</td> <td style="text-align: center;">3 years</td> </tr> <tr> <td>carpenter</td> <td style="text-align: center;">3 years</td> <td style="text-align: center;">3 years</td> </tr> <tr> <td>Plumber</td> <td></td> <td></td> </tr> <tr> <td>Painters</td> <td></td> <td></td> </tr> <tr> <td>Welders</td> <td></td> <td></td> </tr> <tr> <td>Tinsmith</td> <td></td> <td></td> </tr> <tr> <td>First Aider</td> <td></td> <td></td> </tr> <tr> <td>Partime Practitioner</td> <td></td> <td></td> </tr> <tr> <td>Skilled worker</td> <td></td> <td></td> </tr> <tr> <td>Driver</td> <td></td> <td></td> </tr> <tr> <td>Semi-Skilled Labor</td> <td></td> <td></td> </tr> <tr> <td>Laborer</td> <td></td> <td></td> </tr> </tbody> </table>	<u>Key Personnel</u>	<u>General Experience</u>	<u>Relevant Experience</u>	Project Manager,	3 years	3 years	Project Engineers	3 years	3 years	Materials Engineers	3 years	3 years	Foremen	3 years	3 years	Leadman	3 years	3 years	Mason	3 years	3 years	carpenter	3 years	3 years	Plumber			Painters			Welders			Tinsmith			First Aider			Partime Practitioner			Skilled worker			Driver			Semi-Skilled Labor			Laborer		
<u>Key Personnel</u>	<u>General Experience</u>	<u>Relevant Experience</u>																																																					
Project Manager,	3 years	3 years																																																					
Project Engineers	3 years	3 years																																																					
Materials Engineers	3 years	3 years																																																					
Foremen	3 years	3 years																																																					
Leadman	3 years	3 years																																																					
Mason	3 years	3 years																																																					
carpenter	3 years	3 years																																																					
Plumber																																																							
Painters																																																							
Welders																																																							
Tinsmith																																																							
First Aider																																																							
Partime Practitioner																																																							
Skilled worker																																																							
Driver																																																							
Semi-Skilled Labor																																																							
Laborer																																																							
10.5	The minimum major equipment requirements are the following:																																																						
	<table style="width: 100%; border-collapse: collapse;"> <thead> <tr> <th style="text-align: left;"><u>Equipment</u></th> <th style="text-align: center;"><u>Capacity</u></th> <th style="text-align: center;"><u>Number of Units</u></th> </tr> </thead> <tbody> <tr> <td>Backhoe Crawler</td> <td style="text-align: center;">0.80CU.M</td> <td style="text-align: center;">1</td> </tr> <tr> <td>Backhoe wheel Mounted</td> <td style="text-align: center;">0.28cu.m</td> <td style="text-align: center;">1</td> </tr> </tbody> </table>	<u>Equipment</u>	<u>Capacity</u>	<u>Number of Units</u>	Backhoe Crawler	0.80CU.M	1	Backhoe wheel Mounted	0.28cu.m	1																																													
<u>Equipment</u>	<u>Capacity</u>	<u>Number of Units</u>																																																					
Backhoe Crawler	0.80CU.M	1																																																					
Backhoe wheel Mounted	0.28cu.m	1																																																					

	<table border="1"> <tr><td>Dump truck</td><td>12YD³</td><td>2</td></tr> <tr><td>Motorized road grader</td><td>G710A</td><td>1</td></tr> <tr><td>Vibratory roller</td><td>SD100DC (10m.t.)</td><td>1</td></tr> <tr><td>Water Truck/Pump</td><td>16000L</td><td>1</td></tr> <tr><td>Payloader</td><td>1.50cu.m</td><td>1</td></tr> <tr><td>Bulldozer</td><td>d6h SEREIES II PSDS</td><td>1</td></tr> <tr><td>Truck mounted crane</td><td></td><td>1</td></tr> <tr><td>Bar cutter</td><td>single phase</td><td>1</td></tr> <tr><td>Bar bender</td><td></td><td>1</td></tr> <tr><td>Broom truck</td><td></td><td>1</td></tr> <tr><td>One Bagger Mixer</td><td></td><td>1</td></tr> <tr><td>Cargo Truck</td><td>9-10mt 270hp</td><td>1</td></tr> <tr><td>Applicator Machine</td><td></td><td>1</td></tr> <tr><td>Kneeding Machine</td><td></td><td>1</td></tr> <tr><td>Chain Saw</td><td></td><td>1</td></tr> <tr><td>Concrete Vibrator</td><td></td><td>2</td></tr> <tr><td>Concrete Screeder</td><td>5.5hp</td><td>1</td></tr> <tr><td>Concrete Saw</td><td>7.5hp 14" Blade dia</td><td>1</td></tr> <tr><td>Welding Machine</td><td></td><td>1</td></tr> <tr><td>Plate Compactor</td><td>5 hp</td><td>1</td></tr> <tr><td>Pick-up 4x4 vehicle</td><td></td><td>1</td></tr> <tr><td>Minor tools</td><td></td><td>1</td></tr> </table>	Dump truck	12YD ³	2	Motorized road grader	G710A	1	Vibratory roller	SD100DC (10m.t.)	1	Water Truck/Pump	16000L	1	Payloader	1.50cu.m	1	Bulldozer	d6h SEREIES II PSDS	1	Truck mounted crane		1	Bar cutter	single phase	1	Bar bender		1	Broom truck		1	One Bagger Mixer		1	Cargo Truck	9-10mt 270hp	1	Applicator Machine		1	Kneeding Machine		1	Chain Saw		1	Concrete Vibrator		2	Concrete Screeder	5.5hp	1	Concrete Saw	7.5hp 14" Blade dia	1	Welding Machine		1	Plate Compactor	5 hp	1	Pick-up 4x4 vehicle		1	Minor tools		1
Dump truck	12YD ³	2																																																																	
Motorized road grader	G710A	1																																																																	
Vibratory roller	SD100DC (10m.t.)	1																																																																	
Water Truck/Pump	16000L	1																																																																	
Payloader	1.50cu.m	1																																																																	
Bulldozer	d6h SEREIES II PSDS	1																																																																	
Truck mounted crane		1																																																																	
Bar cutter	single phase	1																																																																	
Bar bender		1																																																																	
Broom truck		1																																																																	
One Bagger Mixer		1																																																																	
Cargo Truck	9-10mt 270hp	1																																																																	
Applicator Machine		1																																																																	
Kneeding Machine		1																																																																	
Chain Saw		1																																																																	
Concrete Vibrator		2																																																																	
Concrete Screeder	5.5hp	1																																																																	
Concrete Saw	7.5hp 14" Blade dia	1																																																																	
Welding Machine		1																																																																	
Plate Compactor	5 hp	1																																																																	
Pick-up 4x4 vehicle		1																																																																	
Minor tools		1																																																																	
12	<i>alternative Bids shall not be accepted.</i>																																																																		
15.1	<p>The bid security shall be in the form of a Bid Securing Declaration or any of the following forms and amounts:</p> <ol style="list-style-type: none"> a. The amount of not less than three hundred thousand pesos only (Php300,000.00) [two percent (2%) of ABC], if bid security is in cash, cashier's/manager's check, bank draft/guarantee or irrevocable letter of credit; b. The amount of not less than seven hundred fifty thousand pesos only (Php750,000.00) [five percent (5%) of ABC] if bid security is in Surety Bond. 																																																																		
19.2	N/A																																																																		
20	<i>Within a non-extendible period of five (5) calendar days from receipt by the Bidder of the notice from the BAC that it submitted the Lowest Calculated Bid, the Bidder shall submit its latest income and business tax returns filed and paid through the BIR Electronic Filing and Payment System (eFPS)</i>																																																																		
21	Additional contract documents relevant to the Project that may be required by existing laws and/or the Procuring Entity, such as construction schedule and S-curve, manpower schedule, construction methods, equipment utilization schedule, construction safety and health program approved by the DOLE, and other acceptable tools of project scheduling.																																																																		

Section IV. General Conditions of Contract

Notes on the General Conditions of Contract

The General Conditions of Contract (GCC) in this Section, read in conjunction with the Special Conditions of Contract in Section V and other documents listed therein, should be a complete document expressing all the rights and obligations of the parties.

Matters governing performance of the Contractor, payments under the contract, or matters affecting the risks, rights, and obligations of the parties under the contract are included in the GCC and Special Conditions of Contract.

Any complementary information, which may be needed, shall be introduced only through the Special Conditions of Contract.

1. Scope of Contract

This Contract shall include all such items, although not specifically mentioned, that can be reasonably inferred as being required for its completion as if such items were expressly mentioned herein. All the provisions of RA No. 9184 and its 2016 revised IRR, including the Generic Procurement Manual, and associated issuances, constitute the primary source for the terms and conditions of the Contract, and thus, applicable in contract implementation. Herein clauses shall serve as the secondary source for the terms and conditions of the Contract.

This is without prejudice to Sections 74.1 and 74.2 of the 2016 revised IRR of RA No. 9184 allowing the GPPB to amend the IRR, which shall be applied to all procurement activities, the advertisement, posting, or invitation of which were issued after the effectivity of the said amendment.

2. Sectional Completion of Works

If sectional completion is specified in the **Special Conditions of Contract (SCC)**, references in the Conditions of Contract to the Works, the Completion Date, and the Intended Completion Date shall apply to any Section of the Works (other than references to the Completion Date and Intended Completion Date for the whole of the Works).

3. Possession of Site

4.1. The Procuring Entity shall give possession of all or parts of the Site to the Contractor based on the schedule of delivery indicated in the **SCC**, which corresponds to the execution of the Works. If the Contractor suffers delay or incurs cost from failure on the part of the Procuring Entity to give possession in accordance with the terms of this clause, the Procuring Entity's Representative shall give the Contractor a Contract Time Extension and certify such sum as fair to cover the cost incurred, which sum shall be paid by Procuring Entity.

4.2. If possession of a portion is not given by the above date, the Procuring Entity will be deemed to have delayed the start of the relevant activities. The resulting adjustments in contract time to address such delay may be addressed through contract extension provided under Annex "E" of the 2016 revised IRR of RA No. 9184.

4. The Contractor's Obligations

The Contractor shall employ the key personnel named in the Schedule of Key Personnel indicating their designation, in accordance with **ITB** Clause 10.3 and specified in the **BDS**, to carry out the supervision of the Works.

The Procuring Entity will approve any proposed replacement of key personnel only if their relevant qualifications and abilities are equal to or better than those of the personnel listed in the Schedule.

5. Performance Security

- 5.1. Within ten (10) calendar days from receipt of the Notice of Award from the Procuring Entity but in no case later than the signing of the contract by both parties, the successful Bidder shall furnish the performance security in any of the forms prescribed in Section 39 of the 2016 revised IRR.
- 5.2. The Contractor, by entering into the Contract with the Procuring Entity, acknowledges the right of the Procuring Entity to institute action pursuant to RA No. 3688 against any subcontractor be they an individual, firm, partnership, corporation, or association supplying the Contractor with labor, materials and/or equipment for the performance of this Contract.

6. Site Investigation Reports

The Contractor, in preparing the Bid, shall rely on any Site Investigation Reports referred to in the SCC supplemented by any information obtained by the Contractor.

7. Warranty

- 7.1. In case the Contractor fails to undertake the repair works under Section 62.2.2 of the 2016 revised IRR, the Procuring Entity shall forfeit its performance security, subject its property(ies) to attachment or garnishment proceedings, and perpetually disqualify it from participating in any public bidding. All payables of the GOP in his favor shall be offset to recover the costs.
- 7.2. The warranty against Structural Defects/Failures, except that occasioned-on force majeure, shall cover the period from the date of issuance of the Certificate of Final Acceptance by the Procuring Entity. Specific duration of the warranty is found in the SCC.

8. Liability of the Contractor

Subject to additional provisions, if any, set forth in the SCC, the Contractor's liability under this Contract shall be as provided by the laws of the Republic of the Philippines.

If the Contractor is a joint venture, all partners to the joint venture shall be jointly and severally liable to the Procuring Entity.

9. Termination for Other Causes

Contract termination shall be initiated in case it is determined *prima facie* by the Procuring Entity that the Contractor has engaged, before, or during the implementation of the contract, in unlawful deeds and behaviors relative to contract acquisition and implementation, such as, but not limited to corrupt, fraudulent, collusive, coercive, and obstructive practices as stated in ITB Clause 4.

10. Dayworks

Subject to the guidelines on Variation Order in Annex “E” of the 2016 revised IRR of RA No. 9184, and if applicable as indicated in the SCC, the Dayworks rates in the Contractor’s Bid shall be used for small additional amounts of work only when the Procuring Entity’s Representative has given written instructions in advance for additional work to be paid for in that way.

11. Program of Work

11.1. The Contractor shall submit to the Procuring Entity’s Representative for approval the said Program of Work showing the general methods, arrangements, order, and timing for all the activities in the Works. The submissions of the Program of Work are indicated in the SCC.

11.2. The Contractor shall submit to the Procuring Entity’s Representative for approval an updated Program of Work at intervals no longer than the period stated in the SCC. If the Contractor does not submit an updated Program of Work within this period, the Procuring Entity’s Representative may withhold the amount stated in the SCC from the next payment certificate and continue to withhold this amount until the next payment after the date on which the overdue Program of Work has been submitted.

12. Instructions, Inspections and Audits

The Contractor shall permit the GOP or the Procuring Entity to inspect the Contractor’s accounts and records relating to the performance of the Contractor and to have them audited by auditors of the GOP or the Procuring Entity, as may be required.

13. Advance Payment

The Procuring Entity shall, upon a written request of the Contractor which shall be submitted as a Contract document, make an advance payment to the Contractor in an amount not exceeding fifteen percent (15%) of the total contract price, to be made in lump sum, or at the most two installments according to a schedule specified in the SCC, subject to the requirements in Annex “E” of the 2016 revised IRR of RA No. 9184.

14. Progress Payments

The Contractor may submit a request for payment for Work accomplished. Such requests for payment shall be verified and certified by the Procuring Entity’s Representative/Project Engineer. Except as otherwise stipulated in the SCC, materials and equipment delivered on the site but not completely put in place shall not be included for payment.

15. Operating and Maintenance Manuals

- 15.1. If required, the Contractor will provide “as built” Drawings and/or operating and maintenance manuals as specified in the **SCC**.
- 15.2. If the Contractor does not provide the Drawings and/or manuals by the dates stated above, or they do not receive the Procuring Entity’s Representative’s approval, the Procuring Entity’s Representative may withhold the amount stated in the **SCC** from payments due to the Contractor.

Section V. Special Conditions of Contract

Notes on the Special Conditions of Contract

Similar to the BDS, the clauses in this Section are intended to assist the Procuring Entity in providing contract-specific information in relation to corresponding clauses in the GCC found in Section IV.

The Special Conditions of Contract (SCC) complement the GCC, specifying contractual requirements linked to the special circumstances of the Procuring Entity, the Procuring Entity's country, the sector, and the Works procured. In preparing this Section, the following aspects should be checked:

- a. Information that complements provisions of the GCC must be incorporated.
- b. Amendments and/or supplements to provisions of the GCC as necessitated by the circumstances of the specific purchase, must also be incorporated.

However, no special condition which defeats or negates the general intent and purpose of the provisions of the GCC should be incorporated herein.

Special Conditions of Contract

GCC Clause	
2	The Intended Completion Date is <i>one hundred (150) calendar days which will commence within three calendar days from receipt of the Notice to Proceed.</i>
4.1	<i>three days from the receipt of the Notice to proceed</i>
5	<i>Additional CARI Insurance upon the issuance of Notice to proceed</i>
6	The site investigation reports are: <i>Affidavit of Site Inspection</i>
7.2	<i>In case of semi-permanent structures, such as buildings of types 1, 2, and 3 as classified under the National Building Code of the Philippines, concrete/asphalt roads, concrete river control, drainage, irrigation lined canals, river landing, deep wells, rock causeway, pedestrian overpass, and other similar semi-permanent structures:] Five (5) years.</i>
10	No dayworks are applicable to the contract.
11.1	The Contractor shall submit the Program of Work to the Procuring Entity's Representative for approval within <i>ten (10) days</i> of delivery of the Notice of award.
11.2	The Contractor shall submit to the Procuring Entity's Representative for approval an updated Program of Work every week, the Procuring Entity may withhold the amount of Five thousand pesos only if the contractor failed to Submit the updated program.
13	The amount of the advance payment is <i>15% of the total contract price.</i>
14	<i>The Contractor may submit a request for payment for Work accomplished. Such requests for payment shall be verified and certified by the Procuring Entity's Representative/Project Engineer.</i>
15.1	The date by which operating and maintenance manuals are required is NOT LATER THAN 2 WEEKS AFTER THE COMPLETION OF THE PROJECT The date by which "as built" drawings are required is NOT LATER THAN 2 WEEKS AFTER THE COMPLETION OF THE PROJECT
15.2	The Procuring Entity may withhold the amount Php 1,500,000.00 of the remaining balance of the Contractor failed to submit or produce "as built" drawings.

Section VI. Specification

Section VII. Drawings

[Insert here a list of Drawings. The actual Drawings, including site plans, should be attached to this section, or annexed in a separate folder.]



LOCATION MAP



CADASTRAL MAP

REPUBLIC OF THE PHILIPPINES, PROVINCE OF LAGUNA MUNICIPALITY OF PAETE OFFICE OF THE MUNICIPAL ENGINEER	PROJECT NAME:	PREPARED BY:	RECOMMENDED BY:	APPROVED BY:	SHEET CONTENT:	SHEET NO.:
	CONSTRUCTION OF FARM TO MARKET ROAD	CHRISTIAN LAURENCE R. DIEGO AUTOCAD DRAFTSMAN	NOEL T. VIRAY MUNICIPAL ENGINEER	HON. ROJILYN Q. BAGABALDO MUNICIPAL MAYOR	AS SHOWN	/
	LOCATION: SIBO PAKINAW, Brgy 9 - JENA DEL NORTE, PAETE, LAGUNA					

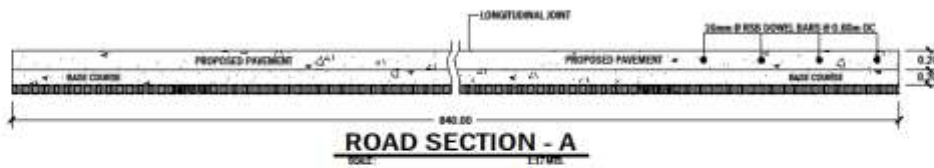
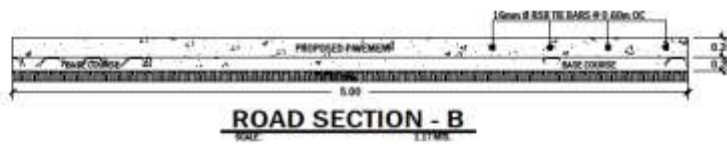
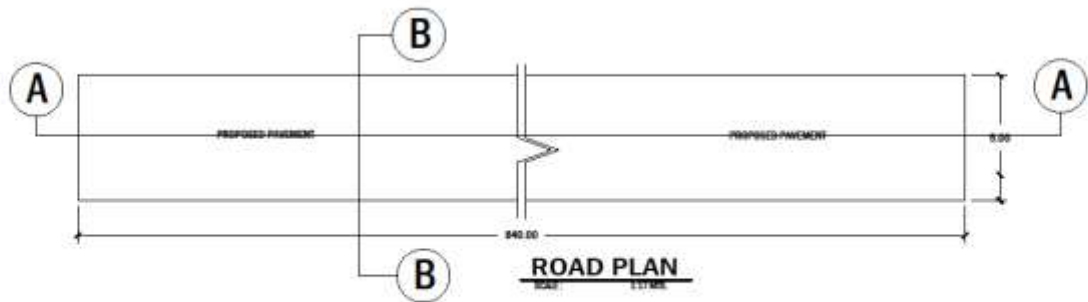

REPUBLIC OF THE PHILIPPINES PROVINCE OF LAGUNA MUNICIPALITY OF PAETE OFFICE OF MUNICIPAL ENGINEER	PROJECT NAME:	PREPARED BY:	RECOMMENDED BY:	APPROVED BY:	SHEET CONTENT:	SHEET NO.:
	CONSTRUCTION OF FARM TO MARKET ROAD				AS SHOWN	/
	LOCATION: SITE: PAPERANG, Brgy 5 BABA DEL NORTE, PAETE, LAGUNA.	CHRISTIAN LAURENCE R. DIEGO AUTOCAD DRAFTSMAN	NOEL T. VIRAY MUNICIPAL ENGINEER	HON. ROJILYN Q. BAGABALDO MUNICIPAL MARFOR		

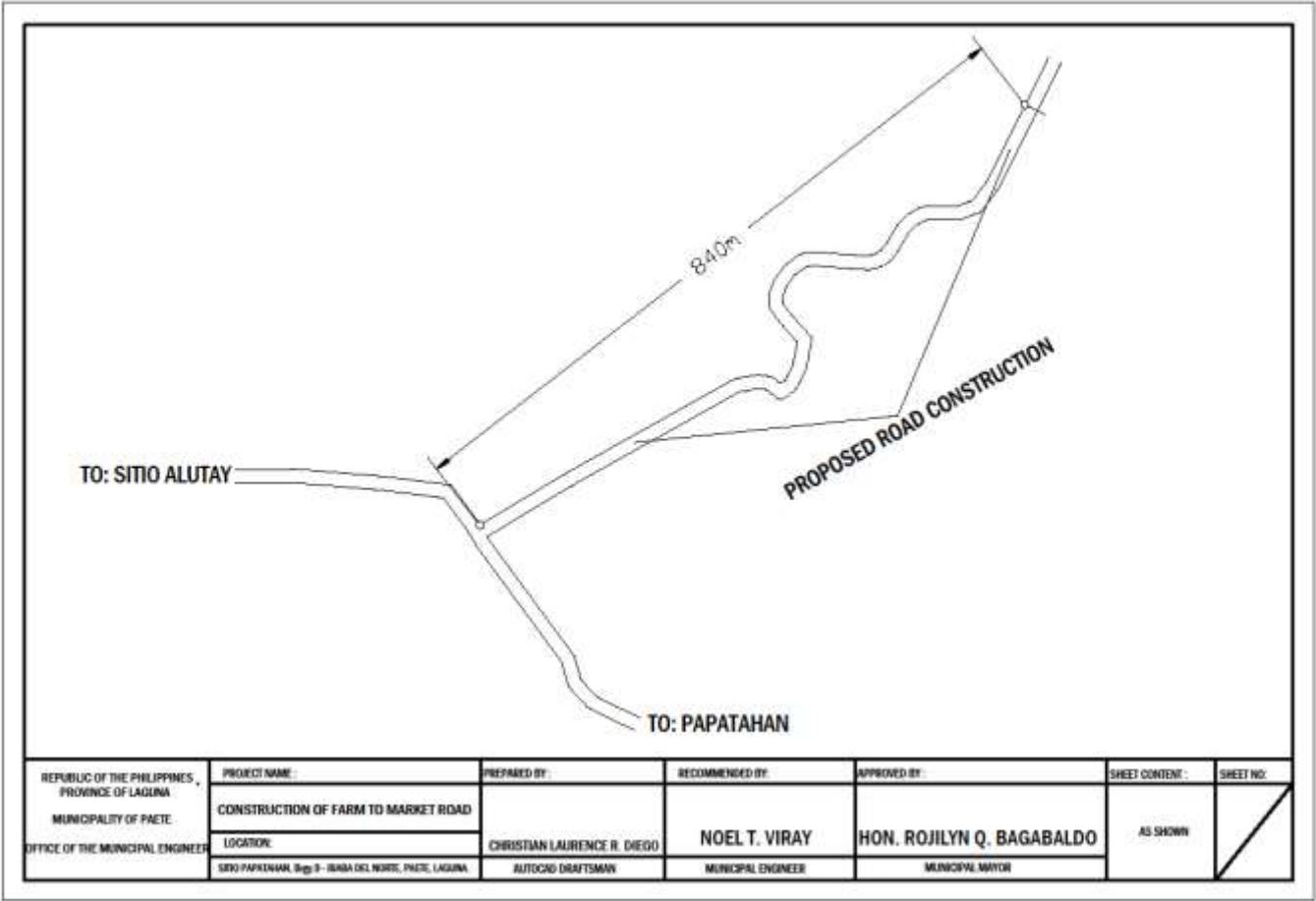

REPUBLIC OF THE PHILIPPINES, PROVINCE OF LAGUNA MUNICIPALITY OF PAETE OFFICE OF THE MUNICIPAL ENGINEER	PROJECT NAME:	PREPARED BY:	RECOMMENDED BY:	APPROVED BY:	SHEET CONTENT:	SHEET NO.:
	CONSTRUCTION OF FARM TO MARKET ROAD		NOEL T. VIRAY	HON. ROJILYN Q. BAGABALDO	AS SHOWN	
	LOCATION:	CHRISTIAN LAURENCE R. DIEGO	MUNICIPAL ENGINEER	MUNICIPAL MAYOR		
	SITO PAPANAHAN, Brgy 9 - JENIA DEL NORTE, PAETE, LAGUNA	AUTOCAD DRAFTSMAN				

Section VIII. Bill of Quantities

Signature Box

A signature box shall be added at the bottom of each page of the Bill of Quantities where the authorized representative of the Bidder shall affix his signature. Failure of the authorized representative to sign each and every page of the Bill of Quantities shall be a cause for rejection of his bid.

Item No. / Description	: A.1.2 (2) Provision of 4x4 Pick Up Type Service Vehicle for the Engineer on Bare Rental Basis					
Unit of Measurement	: mo.					
Output per hour - As Submitted	: .50					
Output per hour - As Evaluated	:					
A.1	Designation		No. of Person/s	No. of Hour/s	Hourly Rate	Amount (PhP)
	Labor					
	a. Driver		1	192	63.11	12,117.12
	Sub - Total for A.1 - As Submitted					12,117.12
A.2	Labor					
	Sub - Total for A.2 - As Evaluated					
	Name and Capacity		No. of Unit/s	No. of Hour/s	Hourly Rate	Amount (PhP)
B.1	Equipment					
	a. Hilux, Pick-up, 4.0 x 4.0 G. 30 lit. MT (diesel engine) 4 Door, 5 Seater		1	192	264.14	50,714.88
	Sub - Total for B.1 As Submitted					50,714.88
B.2	Equipment					
			Lump	Sum		
	Sub - Total for B.2 As Evaluated					
C.1	Total (A.1 + B.1) - As Submitted					62,832.00
C.2	Total (A.2 + B.2) - As Evaluated					
D.1	Output per hour - As Submitted					1
D.2	Output per hour - As Evaluated					
E.1	Direct Unit Cost (C.1+D.1) - As Submitted					62,832.00
E.2	Direct Unit Cost (C.2+D.2) - As Evaluated					
	Name and Capacity		Unit	Quantity	Unit Cost	Amount (PhP)
F.1	Materials					
	a. Diesel		lit.	108	45	4,860.00
	b. Miscellaneous (oil and lubricant) 25% of Diesel				1215	1,215.00
	Sub - Total for F.1 As Submitted					6,075.00
F.2	Materials					
	Sub - Total for F.2 As Evaluated					
G.1	Direct Unit Cost (E.1+F.1) - As Submitted					68,907.00
G.2	Direct Unit Cost (E.2+F.2) - As Submitted					
H.1	Overhead, Contingencies & Miscellaneous (OCM) - As Submitted					
H.2	Overhead, Contingencies & Miscellaneous (OCM) - As Evaluated					
I.1	Contractor's Profit (CP) - As Submitted					
I.2	Contractor's Profit (CP) - As Evaluated					
J.1	Value Added Tax (VAT) - As Submitted			5% of		3,445.35
J.2	Value Added Tax (VAT) - As Evaluated					
K.1	Total Unit Cost - As Submitted					72,352.35
K.2	Total Unit Cost - As Evaluated					

Item No. / Description	: A.1.4 (1) Provision of Progress Photographs					
Unit of Measurement	: Month					
Output per hour - As Submitted	: 1.00					
Output per hour - As Evaluated	:					
A.1	Designation		No. of Person/s	No. of Hour/s	Hourly Rate	Amount (PhP)
	Labor					
	Sub - Total for A.1 - As					
A.2	Labor					
	Sub - Total for A.2 - As					
B.1	Name and Capacity		No. of Unit/s	No. of Hour/s	Hourly Rate	Amount (PhP)
	Equipment					
	Sub - Total for B.1 As					
B.2	Equipment					
	Sub - Total for B.2 As					
C.1	Total (A.1 + B.1) - As					0.00
C.2	Total (A.2 + B.2) - As					
D.1	Output per hour - As					1.00
D.2	Output per hour - As					
E.1	Direct Unit Cost (C.1+D.1) -					0.00
E.2	Direct Unit Cost (C.2+D.2) - As Evaluated					
F.1	Name and Capacity		Unit	Quantity	Unit Cost	Amount (PhP)
	Materials					
	a. Digital Camera		pcs.	1.00	15,000.00	15,000.00
	b. Developing 3R		pcs.	150.00	10.00	1,500.00
	Sub - Total for F.1 As Submitted					16,500.00
F.2	Materials					
	Sub - Total for F.2 As Evaluated					
G.1	Direct Unit Cost (E.1+F.1) - As Submitted					16,500.00
G.2	Direct Unit Cost (E.2+F.2) - As Evaluated					
H.1	Overhead, Contingencies & Miscellaneous (OCM) - As Submitted					
H.2	Overhead, Contingencies & Miscellaneous (OCM) - As Evaluated					
I.1	Contractor's Profit (CP) - As Submitted			8% of G.1		1,650.00
I.2	Contractor's Profit (CP) - As Evaluated					
J.1	Value Added Tax (VAT) - As Submitted			5% of		907.50
J.2	Value Added Tax (VAT) - As Evaluated					
K.1	Total Unit Cost - As Submitted					19,057.50
K.2	Total Unit Cost - As Evaluated					

Item No. / Description	: B.5 (1)	Project Billboard / Signboard			
Unit of Measurement	: Each				
Output per hour - As Submitted	: 2.00				
Output per hour - As Evaluated	:				
A.1	Designation	No. of Person/s	No. of Hour/s	Hourly Rate	Amount (PhP)
	Labor				
	a. Construction Foreman	1	8	90.20	721.60
	b. Skilled Laborer	1	8	65.14	521.12
	c. Laborer	2	8	50.25	804.00
	Sub - Total for A.1 - As Submitted				2,046.72
A.2	Labor				
	Sub - Total for A.2 - As Evaluated				
B.1	Name and Capacity	No. of Unit/s	No. of Hour/s	Hourly Rate	Amount (PhP)
	Equipment				
	a. Minor Tools (10% of Labor Cost)				204.67
	Sub - Total for B.1 As Submitted				204.67
B.2	Equipment				
	Sub - Total for B.2 As Evaluated				
C.1	Total (A.1 + B.1) - As Submitted				2,251.39
C.2	Total (A.2 + B.2) - As Evaluated				
D.1	Output per hour - As Submitted				2.00
D.2	Output per hour - As Evaluated				
E.1	Direct Unit Cost (C.1/D.1) - As Submitted				1,125.70
E.2	Direct Unit Cost (C.2+D.2) - As Evaluated				
F.1	Name and Capacity	Unit	Quantity	Unit Cost	Amount (PhP)
	Materials				
	a. Plywood, 1/4 Marine	pcs.	1	380.00	380.00
	b. Cocolumber	bd.ft.	54	17.00	918.00
	c. Tarpauline	pc.	1	1,000.00	1,000.00
	d. C.W.N.	kg.	1	65.00	65.00
	Sub - Total for F.1 As Submitted				2,363.00
F.2	Materials				
	Sub - Total for F.2 As Evaluated				
G.1	Direct Unit Cost (E.1+F.1) - As Submitted				3,488.70
G.2	Direct Unit Cost (E.2+F.2) - As Evaluated				
H.1	Overhead, Contingencies & Miscellaneous (OCM) - As Submitted		12% of G.1		0.00
H.2	Overhead, Contingencies & Miscellaneous (OCM) - As Evaluated				
I.1	Contractor's Profit (CP) - As Submitted		10% of G.1		348.87
I.2	Contractor's Profit (CP) - As Evaluated				
J.1	Value Added Tax (VAT) - As Submitted		5% of (G.1+H.1+I.1)		191.88
J.2	Value Added Tax (VAT) - As Evaluated				
K.1	Total Unit Cost - As Submitted				4,029.44
K.2	Total Unit Cost - As Evaluated				

Item No. / Description	: B.7 (1) Occupational Safety and Health Program					
Unit of Measurement	: Month					
Output per hour - As Submitted	: 5.00					
Output per hour - As Evaluated	:					
A.1	Designation		No. of Person/s	No. of Hour/s	Hourly Rate	Amount (PhP)
	Labor					
	a. First Aider		1	272	60.11	16,349.92
	b. Part Time Practitioner		1	272	75.93	20,652.96
	Sub - Total for A.1 - As Submitted					37,002.88
A.2	Labor					
	Sub - Total for A.2 - As Evaluated					
B.1	Name and Capacity		No. of Unit/s	No. of Hour/s	Hourly Rate	Amount (PhP)
	Equipment					
	Sub - Total for B.1 As Submitted					
B.2	Equipment					
	Sub - Total for B.2 As Evaluated					
C.1	Total (A.1 + B.1) - As Submitted					37,002.88
C.2	Total (A.2 + B.2) - As Evaluated					
D.1	Output per hour - As Submitted					5.00
D.2	Output per hour - As Evaluated					
E.1	Direct Unit Cost (C.1/D.1) - As Submitted					7,400.58
E.2	Direct Unit Cost (C.2+D.2) - As Evaluated					
F.1	Name and Capacity		Unit	Quantity	Unit Cost	Amount (PhP)
	Materials					
	a. Safety Shoe		Man-Days	1027	2.77	2,844.79
	b. Safety Helmet		Man-Days	1027	0.25	256.75
	c. Safety Gloves		Man-Days	1027	7.67	7,877.09
	d. Face Shield		Man-Days	1027	7.00	7,189.00
	e. Face Mask		Man-Days	1027	6.00	6,162.00
	Sub - Total for F.1 As Submitted					24,329.63
F.2	Materials					
	Sub - Total for F.2 As Evaluated					
G.1	Direct Unit Cost (E.1+F.1) - As Submitted					31,730.21
G.2	Direct Unit Cost (E.2+F.2) - As Evaluated					
H.1	Overhead, Contingencies & Miscellaneous (OCM) - As Submitted			12% of G.1		0.00
H.2	Overhead, Contingencies & Miscellaneous (OCM) - As Evaluated					
I.1	Contractor's Profit (CP) - As Submitted			8% of G.1		3173.02
I.2	Contractor's Profit (CP) - As Evaluated					
J.1	Value Added Tax (VAT) - As Submitted			5% of (G.1+H.1+I.1)		1745.16
J.2	Value Added Tax (VAT) - As Evaluated					
K.1	Total Unit Cost - As Submitted					36,648.39
K.2	Total Unit Cost - As Evaluated					

Item No. / Description	: B.9 Mobilization/Demobilization					
Unit of Measurement	: l.s.					
Output per hour - As Submitted	: 1.00					
Output per hour - As Evaluated	:					
A.1	Designation		No. of Person/s	No. of Hour/s	Hourly Rate	Amount (PhP)
	Labor					
	Sub - Total for A.1 - As Submitted					-
A.2	Labor					
	Sub - Total for A.2 - As Evaluated					
B.1	Name and Capacity		No. of Unit/s	No. of Hour/s	Hourly Rate	Amount (PhP)
	Equipment					
	a. Mobilization/ Demobilization (0.75% of Civil Works)					70,153.32
	Sub - Total for B.1 As Submitted					70,153.32
B.2	Equipment					
	Sub - Total for B.2 As Evaluated					
C.1	Total (A.1 + B.1) - As Submitted					70,153.32
C.2	Total (A.2 + B.2) - As Evaluated					
D.1	Output per hour - As Submitted					1.00
D.2	Output per hour - As Evaluated					
E.1	Direct Unit Cost (C.1/D.1) - As Submitted					70,153.32
E.2	Direct Unit Cost (C.2+D.2) - As Evaluated					
F.1	Name and Capacity		Unit	Quantity	Unit Cost	Amount (PhP)
	Materials					
	Sub - Total for F.1 As Submitted					-
F.2	Materials					
	Sub - Total for F.2 As Evaluated					
G.1	Direct Unit Cost (E.1+F.1) - As Submitted					70,153.32
G.2	Direct Unit Cost (E.2+F.2) - As Evaluated					
H.1	Overhead, Contingencies & Miscellaneous (OCM) - As Submitted			12% of G.1		
H.2	Overhead, Contingencies & Miscellaneous (OCM) - As Evaluated					
I.1	Contractor's Profit (CP) - As Submitted			8% of G.1		
I.2	Contractor's Profit (CP) - As Evaluated					
J.1	Value Added Tax (VAT) - As Submitted			5% of (G.1+H.1+I.1)		3,507.67
J.2	Value Added Tax (VAT) - As Evaluated					
K.1	Total Unit Cost - As Submitted					73,660.99
K.2	Total Unit Cost - As Evaluated					

Item No. / Description	: 100 (1)	Clearing and Grubbing				
Unit of Measurement	: ha.					
Output per hour - As Submitted	: 0.05					
Output per hour - As Evaluated	:					
A.1	Designation		No. of Person/s	No. of Hour/s	Hourly Rate	Amount (PhP)
	Labor					
	a. Construction Foreman		1	1	90.20	90.20
	c. Laborer		2	1	50.25	100.50
	Sub - Total for A.1 - As Submitted					190.70
A.2	Labor					
	Sub - Total for A.2 - As Evaluated					
B.1	Name and Capacity		No. of Unit/s	No. of Hour/s	Hourly Rate	Amount (PhP)
	Equipment					
	a. Dump Truck (12yd ³)		1	1	1,420.00	1,420.00
	b. Payloader		1	1	1,733.00	1,733.00
	c. Bulldozer, D6H SEREIES II PSDS/DD		1	1	3,379.00	3,379.00
	Sub - Total for B.1 As Submitted					6,532.00
B.2	Equipment					
	Sub - Total for B.2 As Evaluated					
C.1	Total (A.1 + B.1) - As Submitted					6,722.70
C.2	Total (A.2 + B.2) - As Evaluated					
D.1	Output per hour - As Submitted					0.05
D.2	Output per hour - As Evaluated					
E.1	Direct Unit Cost (C.1/D.1) - As Submitted					134,454.00
E.2	Direct Unit Cost (C.2+D.2) - As Evaluated					
F.1	Name and Capacity		Unit	Quantity	Unit Cost	Amount (PhP)
	Materials					-
						-
						-
						-
	Sub - Total for F.1 As Submitted					-
F.2	Materials					
	Sub - Total for F.2 As Evaluated					
G.1	Direct Unit Cost (E.1+F.1) - As Submitted					134,454.00
G.2	Direct Unit Cost (E.2+F.2) - As Evaluated					
H.1	Overhead, Contingencies & Miscellaneous (OCM) - As Submitted			15% of G.1		20168.10
H.2	Overhead, Contingencies & Miscellaneous (OCM) - As Evaluated					
I.1	Contractor's Profit (CP) - As Submitted			10% of G.1		13445.40
I.2	Contractor's Profit (CP) - As Evaluated					
J.1	Value Added Tax (VAT) - As Submitted			5% of (G.1+H.1+I.1)		8403.38
J.2	Value Added Tax (VAT) - As Evaluated					
K.1	Total Unit Cost - As Submitted					176,470.88
K.2	Total Unit Cost - As Evaluated					

Item No. / Description	: 100 (3) a1 Individual Removal of Trees, 150mm-300mm dia., Small					
Unit of Measurement	: Each					
Output per hour - As Submitted	: 1.00					
Output per hour - As Evaluated	:					
A.1	Designation	No. of Person/s	No. of Hour/s	Hourly Rate	Amount (PhP)	
	Labor					
	a. Construction Foreman	1	0.33	90.20	29.77	
	b. Skilled Laborer	1	0.33	65.14	21.50	
	c. Laborer	2	0.33	50.25	33.17	
	Sub - Total for A.1 - As Submitted				84.43	
A.2	Labor					
	Sub - Total for A.2 - As Evaluated					
B.1	Name and Capacity	No. of Unit/s	No. of Hour/s	Hourly Rate	Amount (PhP)	
	Equipment					
	a. Back Hoe (0.80 cu.m.)	1	0.25	1,537.00	384.25	
	b. Dump Truck (12yd ³)	1	0.17	1,420.00	241.40	
	c. Chain Saw	1	0.17	75.36	12.81	
	d. Minor Tools (5% of Labor Cost)				4.22	
	Sub - Total for B.1 As Submitted				642.68	
B.2	Equipment					
	Sub - Total for B.2 As Evaluated					
C.1	Total (A.1 + B.1) - As Submitted					727.11
C.2	Total (A.2 + B.2) - As Evaluated					
D.1	Output per hour - As Submitted					1.00
D.2	Output per hour - As Evaluated					
E.1	Direct Unit Cost (C.1/D.1) - As Submitted					727.11
E.2	Direct Unit Cost (C.2+D.2) - As Evaluated					
F.1	Name and Capacity	Unit	Quantity	Unit Cost	Amount (PhP)	
	Materials					
	a. Rope 1" dia. (5 uses)	m	20	3.50	70.00	
	b. Miscellaneous (5% of Materials)				3.50	
	Sub - Total for F.1 As Submitted				73.50	
F.2	Materials					
	Sub - Total for F.2 As Evaluated					
G.1	Direct Unit Cost (E.1+F.1) - As Submitted					800.61
G.2	Direct Unit Cost (E.2+F.2) - As Evaluated					
H.1	Overhead, Contingencies & Miscellaneous (OCM) - As Submitted			15% of G.1		120.09
H.2	Overhead, Contingencies & Miscellaneous (OCM) - As Evaluated					
I.1	Contractor's Profit (CP) - As Submitted			10% of G.1		80.06
I.2	Contractor's Profit (CP) - As Evaluated					
J.1	Value Added Tax (VAT) - As Submitted			5% of (G.1+H.1+I.1)		50.04
J.2	Value Added Tax (VAT) - As Evaluated					
K.1	Total Unit Cost - As Submitted					1,050.80
K.2	Total Unit Cost - As Evaluated					

Item No. / Description	: 102 (1)	Excavation				
Unit of Measurement	: cu.m.					
Output per hour - As Submitted	: 20.00					
Output per hour - As Evaluated	:					
A.1	Designation		No. of Person/s	No. of Hour/s	Hourly Rate	Amount (PhP)
	Labor: Spreading and Compaction					
	a. Construction Foreman		1	1	90.20	90.20
	c. Laborer		3	1	50.25	150.75
	Sub - Total for A.1 - As Submitted					240.95
A.2	Labor					
	Sub - Total for A.2 - As Evaluated					
B.1	Name and Capacity		No. of Unit/s	No. of Hour/s	Hourly Rate	Amount (PhP)
	Equipment					
	a. Dump Truck (12yd ³)		2	1	1,420.00	2,840.00
	b. Payloader (1.50 cu.m.)		1	0.1	1,733.00	173.30
	c. Back Hoe (0.80 cu.m.)		1	1	1,537.00	1,537.00
	Sub - Total for B.1 As Submitted					4,550.30
B.2	Equipment					
	Sub - Total for B.2 As Evaluated					
C.1	Total (A.1 + B.1) - As Submitted					4,791.25
C.2	Total (A.2 + B.2) - As Evaluated					
D.1	Output per hour - As Submitted					20.00
D.2	Output per hour - As Evaluated					
E.1	Direct Unit Cost (C.1/D.1) - As Submitted					239.56
E.2	Direct Unit Cost (C.2+D.2) - As Evaluated					
F.1	Name and Capacity		Unit	Quantity	Unit Cost	Amount (PhP)
	Materials					-
						-
						-
						-
	Sub - Total for F.1 As Submitted					-
F.2	Materials					
	Sub - Total for F.2 As Evaluated					
G.1	Direct Unit Cost (E.1+F.1) - As Submitted					239.56
G.2	Direct Unit Cost (E.2+F.2) - As Evaluated					
H.1	Overhead, Contingencies & Miscellaneous (OCM) - As Submitted			15% of G.1		35.93
H.2	Overhead, Contingencies & Miscellaneous (OCM) - As Evaluated					
I.1	Contractor's Profit (CP) - As Submitted			10% of G.1		23.96
I.2	Contractor's Profit (CP) - As Evaluated					
J.1	Value Added Tax (VAT) - As Submitted			5% of (G.1+H.1+I.1)		14.97
J.2	Value Added Tax (VAT) - As Evaluated					
K.1	Total Unit Cost - As Submitted					314.42
K.2	Total Unit Cost - As Evaluated					

Item No. / Description	: 102 (1)	Selected Borrow for Topping Case 1			
Unit of Measurement	: cu.m.				
Output per hour - As Submitted	: 50.00				
Output per hour - As Evaluated	:				
A.1	Designation	No. of Person/s	No. of Hour/s	Hourly Rate	Amount (PhP)
	Labor: Spreading and Compaction				
	a. Construction Foreman	1	1	90.20	90.20
	c. Laborer	2	1	50.25	100.50
	Sub - Total for A.1 - As Submitted				190.70
A.2	Labor				
	Sub - Total for A.2 - As Evaluated				
B.1	Name and Capacity	No. of Unit/s	No. of Hour/s	Hourly Rate	Amount (PhP)
	Equipment				
	a. Motorized Road Grader, G710A	1	1	2,173.00	2,173.00
	b. Vibratory Roller SD100DC (10 m.t.)	1	1	1,846.00	1,846.00
	c. Water Truck/Pump (16000 L)	1	0.25	2,450.00	612.50
	Sub - Total for B.1 As Submitted				4,631.50
B.2	Equipment				
	Sub - Total for B.2 As Evaluated				
C.1	Total (A.1 + B.1) - As Submitted				4,822.20
C.2	Total (A.2 + B.2) - As Evaluated				
D.1	Output per hour - As Submitted				50.00
D.2	Output per hour - As Evaluated				
E.1	Direct Unit Cost (C.1/D.1) - As Submitted				96.44
E.2	Direct Unit Cost (C.2+D.2) - As Evaluated				
F.1	Name and Capacity	Unit	Quantity	Unit Cost	Amount (PhP)
	Materials				
	Selected Barrow w/ 25% Shrinkage factor	cu.m.	1.25	692.00	865.00
					-
					-
	Sub - Total for F.1 As Submitted				865.00
F.2	Materials				
	Sub - Total for F.2 As Evaluated				
G.1	Direct Unit Cost (E.1+F.1) - As Submitted				961.44
G.2	Direct Unit Cost (E.2+F.2) - As Evaluated				
H.1	Overhead, Contingencies & Miscellaneous (OCM) - As Submitted		15% of G.1		144.22
H.2	Overhead, Contingencies & Miscellaneous (OCM) - As Evaluated				
I.1	Contractor's Profit (CP) - As Submitted		10% of G.1		96.14
I.2	Contractor's Profit (CP) - As Evaluated				
J.1	Value Added Tax (VAT) - As Submitted		5% of (G.1+H.1+I.1)		60.09
J.2	Value Added Tax (VAT) - As Evaluated				
K.1	Total Unit Cost - As Submitted				1,261.90
K.2	Total Unit Cost - As Evaluated				

Item No. / Description	: 311 (1) b1 Portland Cement Concrete Pavement (Unreinforced), 0.20m thk., 14days				
Unit of Measurement	: Square Meter				
Output per hour - As Submitted	: 80.50				
Output per hour - As Evaluated	:				
A.1	Designation	No. of Person/s	No. of Hour/s	Hourly Rate	Amount (PhP)
	Labor				
	a. Construction Foreman	1	1	90.20	90.20
	b. Skilled Laborer	4	1	65.14	260.56
	c. Laborer	12	1	50.25	603.00
	Sub - Total for A.1 - As Submitted				953.76
A.2	Labor				
	Sub - Total for A.2 - As Evaluated				
B.1	Name and Capacity	No. of Unit/s	No. of Hour/s	Hourly Rate	Amount (PhP)
	Equipment				
	a. Concrete Vibrator	2	1	91.25	182.50
	b. Concrete Screeder (5.5 hp)	1	1	545.00	545.00
	c. Concrete Saw (7.5hp) 14" Blade dia.	1	1	32.63	32.63
	d. Bar Cutter Single Phase	1	0.1	219.75	21.98
	e. Minor Tools (5% of Labor Cost)				47.69
	Sub - Total for B.1 As Submitted				829.79
B.2	Equipment				
	Sub - Total for B.2 As Evaluated				
C.1	Total (A.1 + B.1) - As Submitted				1,783.55
C.2	Total (A.2 + B.2) - As Evaluated				
D.1	Output per hour - As Submitted				80.50
D.2	Output per hour - As Evaluated				
E.1	Direct Unit Cost (C.1/D.1) - As Submitted				22.16
E.2	Direct Unit Cost (C.2+D.2) - As Evaluated				
F.1	Name and Capacity	Unit	Quantity	Unit Cost	Amount (PhP)
	Materials				
	a. Ready Mix Concrete 14 days 3500 psi	cu.m.	0.20	7,672.00	1,534.40
	b. Reinforcing Steel Bar	kg	0.39	37.50	14.63
	c. Asphalt Sealant	l	0.12	44.00	5.28
	d. Curing Compound	l	0.29	29.00	8.41
	e. Steel forms rental	m	0.46	51.00	23.46
	f. Concrete Saw (Diamond Blade 14" dia.)	pc	0.00015	8,000.00	1.20
	g. Pipe Sleeve, 2" dia	m	0.0086	97.00	0.83
	h. Grease/Tar	l	0.0056	300.00	1.68
	Sub - Total for F.1 As Submitted				1,589.89
F.2	Materials				
	Sub - Total for F.2 As Evaluated				
G.1	Direct Unit Cost (E.1+F.1) - As Submitted				1,612.05
G.2	Direct Unit Cost (E.2+F.2) - As Evaluated				
H.1	Overhead, Contingencies & Miscellaneous (OCM) - As Submitted		15% of G.1		241.81
H.2	Overhead, Contingencies & Miscellaneous (OCM) - As Evaluated				
I.1	Contractor's Profit (CP) - As Submitted		10% of G.1		161.20
I.2	Contractor's Profit (CP) - As Evaluated				
J.1	Value Added Tax (VAT) - As Submitted		5% of (G.1+H.1+I.1)		100.75
J.2	Value Added Tax (VAT) - As Evaluated				
K.1	Total Unit Cost - As Submitted				2,115.81
K.2	Total Unit Cost - As Evaluated				

Item No. / Description	: 200 (1)	Aggregate Subbase Course				
Unit of Measurement	: cu.m.					
Output per hour - As Submitted	: 50.00					
Output per hour - As Evaluated	:					
A.1	Designation		No. of Person/s	No. of Hour/s	Hourly Rate	Amount (PhP)
	Labor: Spreading and Compaction					
	a. Construction Foreman		1	1	90.20	90.20
	c. Laborer		2	1	50.25	100.50
	Sub - Total for A.1 - As Submitted					190.70
A.2	Labor					
	Sub - Total for A.2 - As Evaluated					
B.1	Name and Capacity		No. of Unit/s	No. of Hour/s	Hourly Rate	Amount (PhP)
	Equipment					
	a. Motorized Road Grader, G710A		1	1	2,173.00	2,173.00
	b. Vibratory Roller SD100DC (10 m.t.)		1	1	1,846.00	1,846.00
	c. Water Truck/Pump (16000 L)		1	0.25	2,450.00	612.50
	Sub - Total for B.1 As Submitted					4,631.50
B.2	Equipment					
	Sub - Total for B.2 As Evaluated					
C.1	Total (A.1 + B.1) - As Submitted					4,822.20
C.2	Total (A.2 + B.2) - As Evaluated					
D.1	Output per hour - As Submitted					50.00
D.2	Output per hour - As Evaluated					
E.1	Direct Unit Cost (C.1/D.1) - As Submitted					96.44
E.2	Direct Unit Cost (C.2+D.2) - As Evaluated					
F.1	Name and Capacity		Unit	Quantity	Unit Cost	Amount (PhP)
	Materials					
	Agg-sub base Course w/ 15% Shrinkage factor		cu.m.	1.15	632.00	726.80
						-
						-
	Sub - Total for F.1 As Submitted					726.80
F.2	Materials					
	Sub - Total for F.2 As Evaluated					
G.1	Direct Unit Cost (E.1+F.1) - As Submitted					823.24
G.2	Direct Unit Cost (E.2+F.2) - As Evaluated					
H.1	Overhead, Contingencies & Miscellaneous (OCM) - As Submitted			15% of G.1		123.49
H.2	Overhead, Contingencies & Miscellaneous (OCM) - As Evaluated					
I.1	Contractor's Profit (CP) - As Submitted			10% of G.1		82.32
I.2	Contractor's Profit (CP) - As Evaluated					
J.1	Value Added Tax (VAT) - As Submitted			5% of (G.1+H.1+I.1)		51.45
J.2	Value Added Tax (VAT) - As Evaluated					
K.1	Total Unit Cost - As Submitted					1,080.51
K.2	Total Unit Cost - As Evaluated					

Item No. / Description	: 400 (1) a Reinforcing Steel Grade 40					
Unit of Measurement	: Kilogram					
Output per hour - As Submitted	: 180.00					
Output per hour - As Evaluated	:					
A.1	Designation		No. of Person/s	No. of Hour/s	Hourly Rate	Amount (PhP)
	Labor					
	a. Construction Foreman		1	1	90.20	90.20
	b. Skilled Laborer		2	1	65.14	130.28
	c. Laborer		8	1	50.25	402.00
	Sub - Total for A.1 - As Submitted					622.48
A.2	Labor					
	Sub - Total for A.2 - As Evaluated					
B.1	Name and Capacity		No. of Unit/s	No. of Hour/s	Hourly Rate	Amount (PhP)
	Equipment					
	a. Bar Cutter		1	0.50	219.75	109.88
	b. Bar Bender		1	0.50	351.50	175.75
	c. Cargo/Service Truck (9-10 mt, 270HP)		1	0.15	1,212.00	181.80
	Sub - Total for B.1 As Submitted					467.43
B.2	Equipment					
	Sub - Total for B.2 As Evaluated					
C.1	Total (A.1 + B.1) - As Submitted					1,089.91
C.2	Total (A.2 + B.2) - As Evaluated					
D.1	Output per hour - As Submitted					180.00
D.2	Output per hour - As Evaluated					
E.1	Direct Unit Cost (C.1/D.1) - As Submitted					6.06
E.2	Direct Unit Cost (C.2+D.2) - As Evaluated					
F.1	Name and Capacity		Unit	Quantity	Unit Cost	Amount (PhP)
	Materials					
	a. Tie Wire (2% of RSB)		kgs.	0.021	70.00	1.47
	b. Reinforcing Steel Bar, Grade 40 (with 5% of Wastage)		kgs.	1.05	37.50	39.38
	Sub - Total for F.1 As Submitted					40.85
F.2	Materials					
	Sub - Total for F.2 As Evaluated					
G.1	Direct Unit Cost (E.1+F.1) - As Submitted					46.90
G.2	Direct Unit Cost (E.2+F.2) - As Evaluated					
H.1	Overhead, Contingencies & Miscellaneous (OCM) - As Submitted			15% of G.1		7.04
H.2	Overhead, Contingencies & Miscellaneous (OCM) - As Evaluated					
I.1	Contractor's Profit (CP) - As Submitted			10% of G.1		4.69
I.2	Contractor's Profit (CP) - As Evaluated					
J.1	Value Added Tax (VAT) - As Submitted			5% of (G.1+H.1+I.1)		2.93
J.2	Value Added Tax (VAT) - As Evaluated					
K.1	Total Unit Cost - As Submitted					61.56
K.2	Total Unit Cost - As Evaluated					

Item No. / Description	: 405 (1) a3 Structural Concrete, 20.68Mpa, 28days					
Unit of Measurement	: Cubic Meter					
Output per hour - As Submitted	: 1.40					
Output per hour - As Evaluated	:					
A.1	Designation		No. of Person/s	No. of Hour/s	Hourly Rate	Amount (PhP)
	Labor					
	a. Construction Foreman		1	1	90.20	90.20
	b. Skilled Laborer		4	1	65.14	260.56
	c. Laborer		8	1	50.25	402.00
	Installation/Removal of Formwork					
	a. Skilled Laborer		4	1	65.14	260.56
	b. Laborer		8	1	50.25	402.00
	Sub - Total for A.1 - As Submitted					1,415.32
A.2	Labor					
	Sub - Total for A.2 - As Evaluated					
B.1	Name and Capacity		No. of Unit/s	No. of Hour/s	Hourly Rate	Amount (PhP)
	Equipment					
	a. One Bagger Mixer		1	1.00	172.00	172.00
	b. Concrete Vibrator		1	1.00	91.25	91.25
	c. Water Truck/Pump (16000 L)		1	0.10	2,450.00	245.00
	d. Minor Tools (5% of Labor Cost)					70.77
	Sub - Total for B.1 As Submitted					579.02
B.2	Equipment					
	Sub - Total for B.2 As Evaluated					
C.1	Total (A.1 + B.1) - As Submitted					1,994.34
C.2	Total (A.2 + B.2) - As Evaluated					
D.1	Output per hour - As Submitted					1.40
D.2	Output per hour - As Evaluated					
E.1	Direct Unit Cost (C.1/D.1) - As Submitted					1,424.53
E.2	Direct Unit Cost (C.2+D.2) - As Evaluated					
F.1	Name and Capacity		Unit	Quantity	Unit Cost	Amount (PhP)
	Materials					
	a. Lumber, Good (4 uses)		bd.ft.	70	65.00	4,550.00
	b. Marine Plywood (1/2"x4"x8")		pcs.	1.6	760.00	1,216.00
	c. Assorted CWN (1 kg/1000 bd.ft. of Lumber)		kgs.	0.7	65.00	45.50
	d. Cement		bag	9.5	225.00	2,137.50
	e. Sand		cu.m.	0.5	817.00	408.50
	f. Gravel		cu.m.	1	972.00	972.00
	g. PVC		ln.m.	0.3	90.00	27.00
	Sub - Total for F.1 As Submitted					9,356.50
F.2	Materials					
	Sub - Total for F.2 As Evaluated					
G.1	Direct Unit Cost (E.1+F.1) - As Submitted					10,781.03
G.2	Direct Unit Cost (E.2+F.2) - As Evaluated					
H.1	Overhead, Contingencies & Miscellaneous (OCM) - As Submitted			15% of G.1		1617.15
H.2	Overhead, Contingencies & Miscellaneous (OCM) - As Evaluated					
I.1	Contractor's Profit (CP) - As Submitted			10% of G.1		1078.10
I.2	Contractor's Profit (CP) - As Evaluated					
J.1	Value Added Tax (VAT) - As Submitted			5% of (G.1+H.1+I.1)		673.81
J.2	Value Added Tax (VAT) - As Evaluated					
K.1	Total Unit Cost - As Submitted					14,150.10
K.2	Total Unit Cost - As Evaluated					

Item No. / Description	: 506 (1)	Stone Masonrys				
Unit of Measurement	: Cubic Meter					
Output per hour - As Submitted	: 1.60					
Output per hour - As Evaluated	:					
A.1	Designation		No. of Person/s	No. of Hour/s	Hourly Rate	Amount (PhP)
	Labor					
	a. Construction Foreman		1	1	90.20	90.20
	b. Skilled Laborer		2	1	65.14	130.28
	c. Laborer		8	1	50.25	402.00
	Sub - Total for A.1 - As Submitted					622.48
A.2	Labor					
	Sub - Total for A.2 - As Evaluated					
B.1	Name and Capacity		No. of Unit/s	No. of Hour/s	Hourly Rate	Amount (PhP)
	Equipment					
	a. One Bagger Mixer		1	1.00	172.00	172.00
	b. Back Hoe (wheel Type 0.28 cu.m.)		1	0.10	922.00	92.20
	c. Water Truck/Pump (16000 L)		1	0.05	2,450.00	122.50
	d. Minor Tools (10% of Labor Cost)					62.25
	Sub - Total for B.1 As Submitted					448.95
B.2	Equipment					
	Sub - Total for B.2 As Evaluated					
C.1	Total (A.1 + B.1) - As Submitted					1,071.43
C.2	Total (A.2 + B.2) - As Evaluated					
D.1	Output per hour - As Submitted					1.60
D.2	Output per hour - As Evaluated					
E.1	Direct Unit Cost (C.1/D.1) - As Submitted					669.64
E.2	Direct Unit Cost (C.2+D.2) - As Evaluated					
F.1	Name and Capacity		Unit	Quantity	Unit Cost	Amount (PhP)
	Materials					
	a. Boulders		cu.m.	1.05	1,022.00	1,073.10
	b. Cement		bag	5.5	225.00	1,237.50
	c. Sand		cu.m.	0.3	817.00	245.10
	d. Gravel		cu.m.	0.02	972.00	19.44
	e. Weep Holes (PVC)		l.m.	0.3	80.00	24.00
	f. Filter Cloth		sq.m.	0.015	180.00	2.70
	Sub - Total for F.1 As Submitted					2,601.84
F.2	Materials					
	Sub - Total for F.2 As Evaluated					
G.1	Direct Unit Cost (E.1+F.1) - As Submitted					3,271.48
G.2	Direct Unit Cost (E.2+F.2) - As Evaluated					
H.1	Overhead, Contingencies & Miscellaneous (OCM) - As Submitted			15% of G.1		490.72
H.2	Overhead, Contingencies & Miscellaneous (OCM) - As Evaluated					
I.1	Contractor's Profit (CP) - As Submitted			10% of G.1		327.15
I.2	Contractor's Profit (CP) - As Evaluated					
J.1	Value Added Tax (VAT) - As Submitted			5% of (G.1+H.1+I.1)		204.47
J.2	Value Added Tax (VAT) - As Evaluated					
K.1	Total Unit Cost - As Submitted					4,293.82
K.2	Total Unit Cost - As Evaluated					

Item No. / Description	: 100 (3) a1 Individual Removal of Trees, 150mm-300mm dia., Small					
Unit of Measurement	: Each					
Output per hour - As Submitted	: 1.00					
Output per hour - As Evaluated	:					
A.1	Designation		No. of Person/s	No. of Hour/s	Hourly Rate	Amount (PhP)
	Labor					
	a. Construction Foreman		1	0.57	90.20	51.41
	b. Skilled Laborer		2	0.57	65.14	74.26
	c. Laborer		4	0.57	50.25	114.57
	Sub - Total for A.1 - As Submitted					240.24
A.2	Labor					
	Sub - Total for A.2 - As Evaluated					
B.1	Name and Capacity		No. of Unit/s	No. of Hour/s	Hourly Rate	Amount (PhP)
	Equipment					
	a. Back Hoe (0.80 cu.m.)		1	0.29	1,537.00	445.73
	b. Plate Compactor (5 Hp)		1	0.29	123.00	35.67
	c. Minor Tools (10% of Labor Cost)					24.02
	Sub - Total for B.1 As Submitted					505.42
B.2	Equipment					
	Sub - Total for B.2 As Evaluated					
C.1	Total (A.1 + B.1) - As Submitted					745.67
C.2	Total (A.2 + B.2) - As Evaluated					
D.1	Output per hour - As Submitted					1.00
D.2	Output per hour - As Evaluated					
E.1	Direct Unit Cost (C.1/D.1) - As Submitted					745.67
E.2	Direct Unit Cost (C.2+D.2) - As Evaluated					
F.1	Name and Capacity		Unit	Quantity	Unit Cost	Amount (PhP)
	Materials					
	a. Portland Cement		bag	1.08	225.00	243.00
	b. Sand		cu.m.	0.061	817.00	49.84
	c. RC Pipes (910 mm dia) Class II		pc.	1	3,540.00	3,540.00
	d. Sand Bedding/ Selected Sandy Soil		su.m.	0.128	817.00	104.58
	Sub - Total for F.1 As Submitted					3,937.41
F.2	Materials					
	Sub - Total for F.2 As Evaluated					
G.1	Direct Unit Cost (E.1+F.1) - As Submitted					4,683.08
G.2	Direct Unit Cost (E.2+F.2) - As Evaluated					
H.1	Overhead, Contingencies & Miscellaneous (OCM) - As Submitted			15% of G.1		702.46
H.2	Overhead, Contingencies & Miscellaneous (OCM) - As Evaluated					
I.1	Contractor's Profit (CP) - As Submitted			10% of G.1		468.31
I.2	Contractor's Profit (CP) - As Evaluated					
J.1	Value Added Tax (VAT) - As Submitted			5% of (G.1+H.1+I.1)		292.69
J.2	Value Added Tax (VAT) - As Evaluated					
K.1	Total Unit Cost - As Submitted					6,146.54
K.2	Total Unit Cost - As Evaluated					

Section IX. Checklist of Technical and Financial Documents

Notes on the Checklist of Technical and Financial Documents

The prescribed documents in the checklist are mandatory to be submitted in the Bid, but shall be subject to the following:

- a. GPPB Resolution No. 09-2020 on the efficient procurement measures during a State of Calamity or other similar issuances that shall allow the use of alternate documents in lieu of the mandated requirements; or
- b. any subsequent GPPB issuances adjusting the documentary requirements after the effectivity of the adoption of the PBDs.

The BAC shall be checking the submitted documents of each Bidder against this checklist to ascertain if they are all present, using a non-discretionary “pass/fail” criterion pursuant to Section 30 of the 2016 revised IRR of RA No. 9184.

Checklist of Technical and Financial Documents

I. TECHNICAL COMPONENT ENVELOPE

Class “A” Documents

Legal Documents

- (a) Valid PhilGEPS Registration Certificate (Platinum Membership) (all pages);
or
- (b) Registration certificate from Securities and Exchange Commission (SEC), Department of Trade and Industry (DTI) for sole proprietorship, or Cooperative Development Authority (CDA) for cooperatives or its equivalent document;
and
- (c) Mayor’s or Business permit issued by the city or municipality where the principal place of business of the prospective bidder is located, or the equivalent document for Exclusive Economic Zones or Areas;
and
- (e) Tax clearance per E.O. No. 398, s. 2005, as finally reviewed and approved by the Bureau of Internal Revenue (BIR).

Technical Documents

- (f) Statement of the prospective bidder of all its ongoing government and private contracts, including contracts awarded but not yet started, if any, whether similar or not similar in nature and complexity to the contract to be bid; **and**
- (g) Statement of the bidder’s Single Largest Completed Contract (SLCC) similar to the contract to be bid, except under conditions provided under the rules;
and
- (h) Philippine Contractors Accreditation Board (PCAB) License;
or
Special PCAB License in case of Joint Ventures;
and registration for the type and cost of the contract to be bid; **and**
- (i) Original copy of Bid Security. If in the form of a Surety Bond, submit also a certification issued by the Insurance Commission;
or
Original copy of Notarized Bid Securing Declaration; **and**
- (j) Project Requirements, which shall include the following:
 - a. Organizational chart for the contract to be bid;
 - b. List of contractor’s key personnel (*e.g.*, Project Manager, Project Engineers, Materials Engineers, and Foremen), to be assigned to the contract to be bid, with their complete qualification and experience data;
 - c. List of contractor’s major equipment units, which are owned, leased, and/or under purchase agreements, supported by proof of ownership or certification of availability of equipment from the equipment lessor/vendor for the duration of the project, as the case may be; **and**
- (k) Original duly signed Omnibus Sworn Statement (OSS);

and if applicable, Original Notarized Secretary's Certificate in case of a corporation, partnership, or cooperative; or Original Special Power of Attorney of all members of the joint venture giving full power and authority to its officer to sign the OSS and do acts to represent the Bidder.

Financial Documents

- (l) The prospective bidder's audited financial statements, showing, among others, the prospective bidder's total and current assets and liabilities, stamped "received" by the BIR or its duly accredited and authorized institutions, for the preceding calendar year which should not be earlier than two (2) years from the date of bid submission; **and**
- (m) The prospective bidder's computation of Net Financial Contracting Capacity (NFCC).

Class "B" Documents

- (n) If applicable, duly signed joint venture agreement (JVA) in accordance with RA No. 4566 and its IRR in case the joint venture is already in existence; **or** duly notarized statements from all the potential joint venture partners stating that they will enter into and abide by the provisions of the JVA in the instance that the bid is successful.

II. FINANCIAL COMPONENT ENVELOPE

- (o) Original of duly signed and accomplished Financial Bid Form; **and**

Other documentary requirements under RA No. 9184

- (p) Original of duly signed Bid Prices in the Bill of Quantities; **and**
- (q) Duly accomplished Detailed Estimates Form, including a summary sheet indicating the unit prices of construction materials, labor rates, and equipment rentals used in coming up with the Bid; **and**
- (r) Cash Flow by Quarter.

